

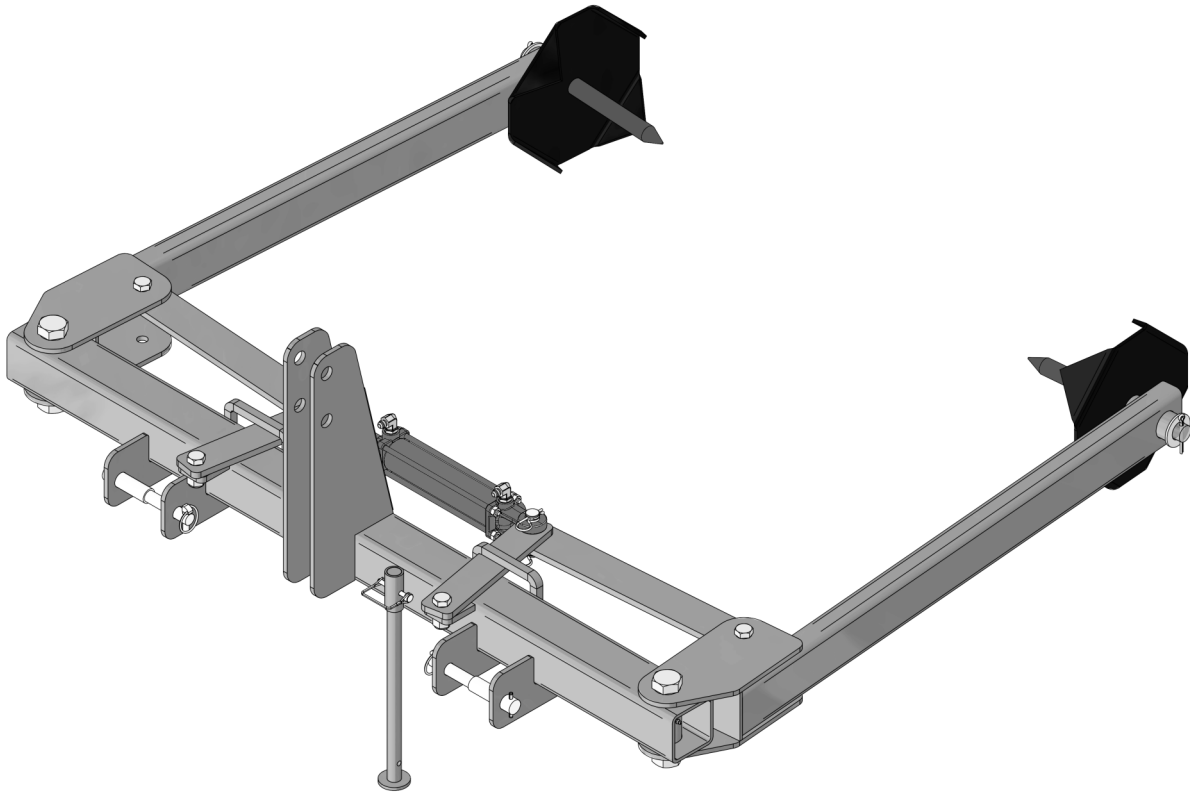

Bale Unroller

TRBU-100



Operator's Manual

Rel. 12/25

Page left blank intentionally

TO THE DEALER:

Assembly and proper installation of this product is the responsibility of the Tar River dealer. Read manual instructions and safety rules. Make sure all items on the Dealer's Pre-Delivery and Delivery Check Lists in the Owner's/Operator's Manual are completed before releasing equipment to the owner.

TO THE OWNER:

Read this manual before operating your Tar River equipment. The information presented will prepare you to do a better and safer job. Keep this manual handy for ready reference. Require all operators to read this manual carefully and become acquainted with all the adjustment and operating procedures before attempting to operate. Replacement manuals can be obtained from your selling dealer. The equipment you have purchased has been carefully engineered and manufactured to provide dependable and satisfactory use. Like all mechanical products, it will require cleaning and upkeep. Lubricate the unit as specified. Observe all safety information in this manual and safety decals on the equipment. For service, your authorized Tar River dealer has trained mechanics, genuine Tar River service parts, and the necessary tools and equipment to handle all your needs. Use only genuine Tar River service parts. Substitute parts will void the warranty and may not meet standards required for safe and satisfactory operation.

Record your implement model and serial number in the space provide below. Your dealer will need this information to give you prompt, efficient service.

Model Number: _____

Serial Number: _____

Date Purchased: _____

TO THE DEALER: Part 1 of 2

Assembly and proper installation of this product is the responsibility of the Belco Resources Dealer. Read manual instructions and safety rules. Make sure all items on the Dealer’s Pre-Delivery List and Owners Check List in the Owner’s/Operator’s Manual are completed before releasing equipment to the owner.



NOTE: The machine must be inspected thoroughly by the dealer prior to delivery of machine to owner. Place a check mark in the box beside each item checked. Contact Belco Recourses Equipment of any damages, issues or shortages to the machine.

Pre-Delivery Checklist - Dealer

- Gearbox oil level
- Check all fluids, hydraulic, gear oil, etc.
- Grease fittings properly lubricated
- Guards, shields, attachments securely fastened
- All hardware tightened
- Condition and tension of V-belts (if applicable)
- Blades properly installed, blade hardware tightened to proper torque specifications
- PTO attached to the machine (if applicable)
- All decals are clean, legible and in proper location
- Operator’s Manual on machine

Model #: _____ Serial #: _____

Inspected by (Initials): _____ Date: _____

TO THE DEALER: Part 2 of 2

Dealer is to review the following items to the owner. Place a check mark in the box beside each item reviewed.

Checklist - Owner

- Correct attachment of machine to tractor
- Safe operation of the machine
- Importance of regular lubrication, maintenance and inspection
- Troubleshooting
- Replacing broken or worn parts (importance of using only OEM parts)
- Servicing the machine
- Storage
- Warranty
- Encourage owner to read and understand the Operator’s Manual before operating the machine
- Encourage owner to fill out the “Warranty Registration”, online warranty@br-equipment.com

Purchase Date: _____	Delivery Date: _____
Model #: _____	Serial #: _____
Dealer Signature _____	Date: _____
Customer Signature _____	Date: _____

TO THE OWNER:

Read this manual before operating your Belco Resources equipment. The information presented will prepare you to do a better and safer job. Keep this manual handy for ready reference. Require all operators to read this manual carefully and become acquainted with all the adjustment and operating procedures before attempting to operate. Replacement manuals can be obtained from your selling dealer. The equipment you have purchased has been carefully engineered and manufactured to provide dependable and satisfactory use. Like all mechanical products, it will require cleaning and upkeep. Lubricate the machine as specified. Observe all safety information in this manual and safety decals on the equipment. For service, your authorized Belco Resources dealer has trained mechanics, genuine Belco Resources service parts, and the necessary tools and equipment to handle all your needs. Use only genuine Belco Resources service parts. Substitute parts will void the warranty and may not meet standards required for safe and satisfactory operation.

Table of Contents

Introduction	7
Technical Specifications	7
Safety	8
Safety Signal Words	8
General Safety Guidelines	9
Safety Decal Care	9
Before Operation	10
During Operation	11
Highway And Transport Operations	12-13
Attaching to Tractor.....	14-15
Operating Instructions	16-17
Maintenance/Storage.....	18
Torque Specifications	19
Parts Breakdown	21-27
Warranty	28

Introduction

Thank you for purchasing your Tar River Bale Unroller. It is designed to mount easily on your tractor's 3-point hitch, grips the bale at both ends and rotates on a central axis, using ground friction to unroll hay like a carpet-no additional tools needed. Ideal for feeding large round bales, it reduces waste by unrolling only what cattle will eat in an hour. Feed from the tractor seat while minimizing manure buildup and naturally spreading seeds across your pasture.

Technical Specifications

Model:	TRBU-100
Bale Size	4' & 5'
Hydraulic Opening	Standard
Weight	310 lbs.

Important Safety Information

Safety

It is important that you read the entire manual and to become familiar with this product before you begin using it. This product is designed for certain applications only. The manufacturer cannot be responsible for issues arising from modification. We strongly recommend this product not be modified and /or used for any application other than that for which it is designed. If you have any questions relative to a particular application, DO NOT use the product until you have first contacted us to determine if it can or should be performed on the product.

Read and understand this manual and all safety signs before operating and maintaining . Review the safety instructions and precautions annually.

Safety Signal Words

TAKE NOTE! This safety alert symbol found though out this manual is used to call you attention to instructions involving you personal safety and the safety of others. Failure to follow these instructions can result in injury or death.



**This symbol means:
Attention!
Become alert!
Your safety is involved!**

Note the use of the signal words, **DANGER**, **WARNING** and **CAUTION** with the safety messages. The appropriate signal word for each has been selected using the following guidelines:



DANGER: Indicates an imminently hazardous situation that, if not avoided, will result in death or serious injury. This signal word is to be limited to the most extreme situations typically for machine components which, for functional purposes, cannot be guarded.



WARNING: Indicates a potentially hazardous situation that, if not avoided, could result in death or serious injury, and includes hazards that are exposed when guards are removed. It may also be used to alert against unsafe practices.



CAUTION: Indicates a potentially hazardous situation that, if not avoided, may result in minor or moderate injury. It may also be used to alert against unsafe practices.

Important Safety Information

General Safety Guidelines

Safety of the operator is one of the main concerns in designing and developing a new piece of equipment. Designers and manufacturers build in as many safety features as possible. However, every year many accidents occur which could have been avoided by a few seconds of thought and a more careful approach to handling equipment. You, the operator, can avoid many accidents by observing the following precautions in this section. To avoid personal injury, study the following precautions and insist those working with you, or for you, follow them.

Replace any **DANGER, WARNING, CAUTION** or instruction safety decal that is not readable or is missing. Location of such decals are indicated in this manual. Do not attempt to operate this equipment under the influence of drugs or alcohol.

Review the safety instructions with all users annually.

This equipment is dangerous to children and persons unfamiliar with its operation. The operator should be a responsible adult familiar with farm machinery and trained in this equipment's operations. **Do not allow persons to operate or assemble this unit until they have read this manual and have developed a thorough understanding of the safety precautions and of how it works.**

To prevent injury of death, use a tractor equipped with a Roll Over Protection System (ROPS). Do not paint over, remove or deface any signs or warning decals on your equipment. Observe all safety signs and practice the instructions on them.

Never exceed the limits of a piece of machinery. If its ability to do a job, or to do so safely, is in question - **Don't try it!**



Safety Decal Care

- Keep safety signs clean and legible at all times.
- Replace safety signs that are missing or have become illegible.
- Replaced parts that displayed a safety sign should also display the current safety sign
- Safety signs are available from your Distributor or Dealer Parts Department or the factory.

Important Safety Information

How to Install Safety Signs

- Be sure that the installation area is clean and dry.
- Decide on the exact position before you remove the backing paper.
- Remove the smallest portion of the split backing paper.
- Align the decal over the specified area and carefully press the small portion with the exposed sticky backing in place.
- Slowly peel back the remaining paper and carefully smooth the remaining portion of the decal in place.
- Small air pockets can be pierced with a straight pin and smoothed out using the piece of decal backing paper.



Before Operation

- Carefully study and understand this manual.
- Do not wear loose-fitting clothing, which may catch in moving parts.
- Always wear protective clothing and substantial shoes.
- Assure that all tires are inflated evenly.
- Give the machine a visual inspection for any loose bolts, worn parts or cracked welds, and make necessary repairs. Follow the maintenance safety instructions included with this manual.
- Be sure that there are no tools lying on or in the equipment.
- Do not use the machine until you are sure that the area is clear, especially of children and animals.
- Don't hurry the learning process or take the machine for granted. Ease into it and become familiar with your new equipment.
- Practice operation of your equipment and its attachments. Completely familiarize yourself and other operators with its operation before using.
- Use a tractor equipped with a Roll Over Protection System (ROPS) and fasten your seat belt prior to starting engine.
- The manufacturer does not recommend usage of tractor with ROPS removed.
- Move tractor wheels to the widest recommended settings to increase stability.
- Securely attach to towing unit. Use a high strength, appropriately sized hitch pin with a mechanical retainer and attach safety chain.
- Do not allow anyone to stand between the tongue or hitch and the towing vehicle when backing up to the equipment.

Important Safety Information



During Operation

- Children should not be allowed on the product.
- Clear the area of small children and bystanders before moving the machine.
- If using a towing unit, securely attach machine by using a hardened 3/4" pin, a metal retainer, and safety chains if required. Shift towing unit to a lower gear before going down steep downgrades, thus using the engine as a retarding force. Keep towing vehicle in gear at all times. Slow down for corners and rough terrain.
- Make sure you are in compliance with all local and state regulations regarding transporting equipment on public roads and highways. Lights and slow moving signs must be clean and visible by overtaking or oncoming traffic when machine is transported.
- Beware of bystanders, **particularly children!** Always look around to make sure that it is safe to start the engine of the towing vehicle or move the machine. This is particularly important with higher noise levels and quiet cabs, as you may not hear people shouting.
- **NO PASSENGERS ALLOWED!** Do not carry passengers anywhere on, or in, the tractor or equipment, except as required for operation.
- Keep hands and clothing clear of moving parts.
- Do not clean, lubricate or adjust your equipment while it is moving.
- When halting operation, even periodically, set the tractor or towing vehicle brakes, disengage the PTO, shut off the engine and **remove the ignition key.**
- Be especially observant of the operating area and terrain. Watch for holes, rocks or hidden hazards. Always inspect the area prior to operation.
- **DO NOT** operate near the edge of drop-offs or banks.
- **DO NOT** operate on steep slopes as overturns may result.
- Operate up and down (not across) intermediate slopes. Avoid sudden starts and stops.



Warning: Never backup with the machine on the ground! This will cause damage to the machine. Always lift the machine high enough to clear the ground before backing up.

Important Safety Information



Highway and Transport Operations

- Adopt safe driving practices.
- Keep the brake pedals latched together at all times. **Never use independent braking with machine in tow as loss of control and/or upset of machine can result.**
- Always drive at a safe speed relative to local conditions and ensure that your speed is low enough for an emergency stop to be safe and secure. Keep speed at a minimum.
- Reduce speed prior to turns to avoid the risk of overturning.
- Avoid sudden uphill turns on steep slopes.
- Always keep the tractor or towing vehicle in gear to provide engine braking when going downhill. Do not coast.
- Do not drink and drive!
- Comply with state and local laws governing highway safety and movement of farm machinery on public roads.
- Use approved accessory lighting flags and necessary warning devices to protect operators of other vehicles on the highway during daylight and nighttime transport. Various safety lights and devices are available from your dealer.
- The use of flashing amber lights is acceptable in most localities. However, some localities prohibit their use. Local laws should be checked for all highway and marking requirements.
- When driving the tractor and equipment on the road or highway under 40 kph (20 mph) at night or during the day, use the amber warning lights and a slow moving vehicle (SMV) identification emblem.
- Plan your route to avoid heavy traffic.
- Be a safe and courteous driver. Always yield to oncoming traffic in all situations, including narrow bridges, intersections, etc.
- Be observant of bridge loading ratings. Do not cross bridges rated at lower than the gross weight at which you are operating.
- Watch for obstructions overhead and to the side while transporting.
- Always operate in a position to provide maximum visibility at all times. Make allowances for increased length and weight of the equipment when making turns, stopping the machine, etc.
- Pick the most level route when transporting across fields. Avoid the edges of ditches or gullies and steep hillsides.
- Be extra careful when working in inclines.

Important Safety Information



Highway and Transport Operations

- Maneuver the tractor or towing vehicle at safe speeds.
- Avoid overhead wires or other obstacles. Contact with overhead lines could cause serious injury or death.
- Avoid loose fill, rocks and holes, they can be dangerous for equipment operation or movement.
- Allow for machine length when making turns,
- Operate the towing vehicle from the operator's seat only.
- Never stand alongside of machine with engine running or attempt to start engine and/or operate machine while standing alongside of machine.
- Never leave running equipment attachments unattended.
- As a precaution, always recheck the hardware on equipment following every 100 hours of operation. Correct all problems. Follow the maintenance safety procedures.

Attaching to Tractor



Warning: When attaching the machine, *Never* allow anyone to stand between the machine and the tractor. Serious injury or death can occur!

Attaching the Machine

- Back up the tractor to the machine , while lining up the lower tractor links to the machine lower pins.
- Stop the engine, set the brake and remove the key from the tractor and block the tractor tires.
- Secure the lower tractor arms to the wood chipper lower pins with lynch pins.
- Attach the tractor top link to the machine with the top link pin and r-clip.
- Adjust the tractor sway bars/chains to center the machine and remove excess sway.
- Adjust lower links and top link so that the machine is level.
- Operate the tractor hydraulic controls very slowly up and down. There should be no contact between the machine or any part of the tractor. Failure to check clearance can result in damage to the machine, tractor (especially the tires) and possible injury to the operator. Maintain no less than 6” of clearance between the

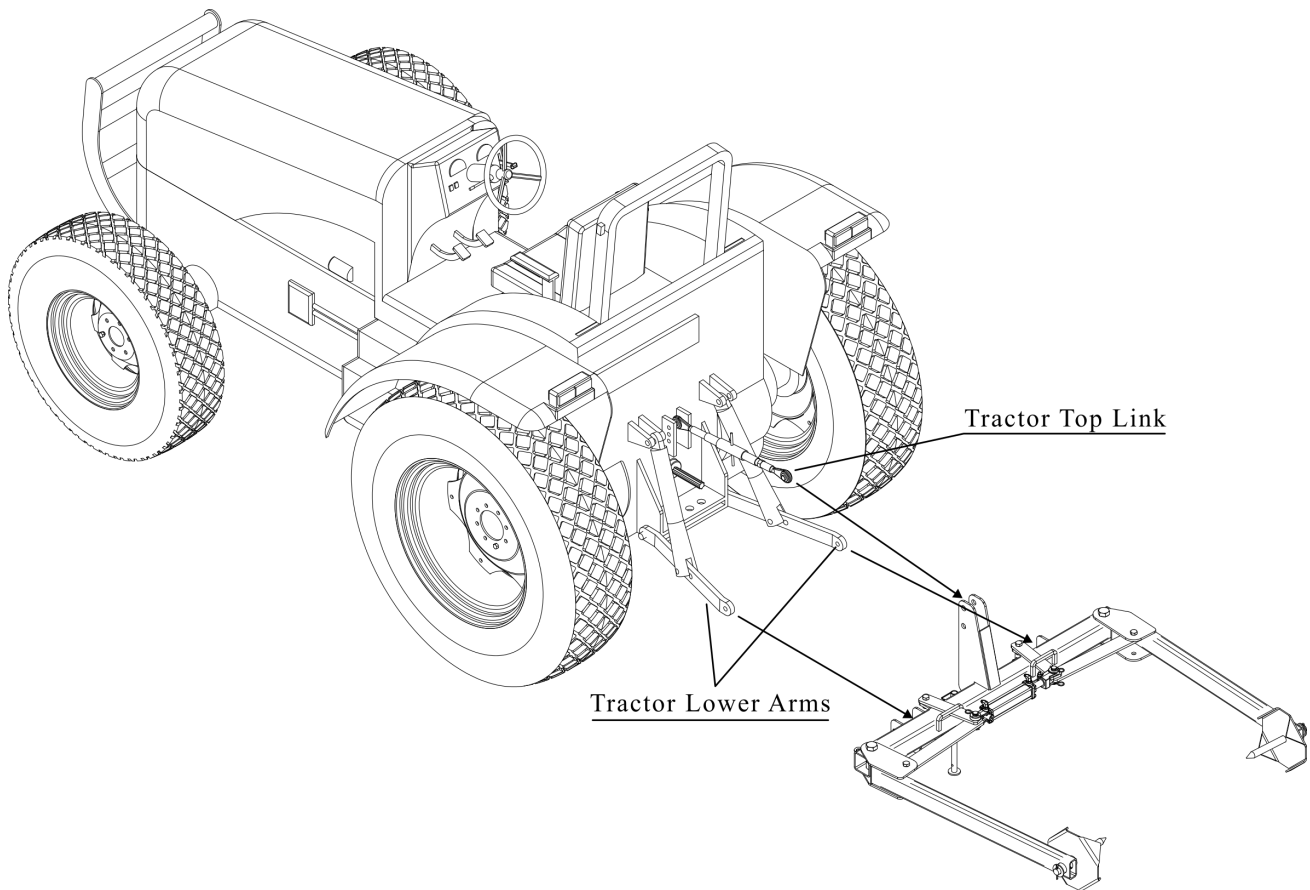

Warning: Never backup with the machine on the ground! This will cause damage to the machine. Always lift the machine high enough to clear the ground before backing up.

Attaching to Tractor

Attaching the Machine, cont.

- There are two versions of the TRBU frame. Version 1 has three hitch plates per side versus the Version 2 that has two hitch plates per side. Each uses a different configuration of pins.
- **Version 1:** The hitch pin can be placed in one of two positions depending on the tractor. If the tractor uses Cat 1, insert the pin thru the inside plate as shown, (**Cat 1 Position**). If the tractor uses Cat2, insert pin along with bushing thru the outside plate as shown, (**Cat 2 Position**).
- **Version 2:** This version attaches to the tractor using a Cat 1/Cat 2 pin.

Frame Version 1

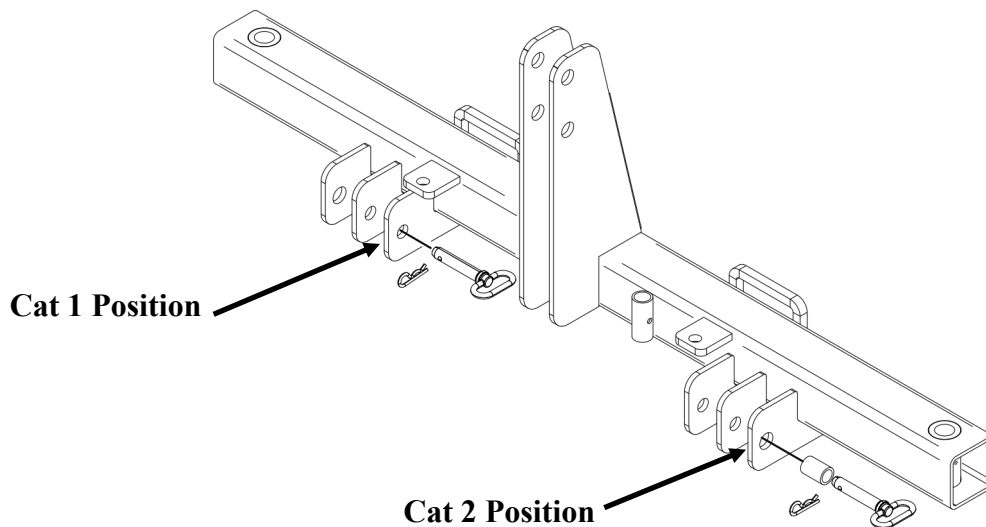

Frame Version 2

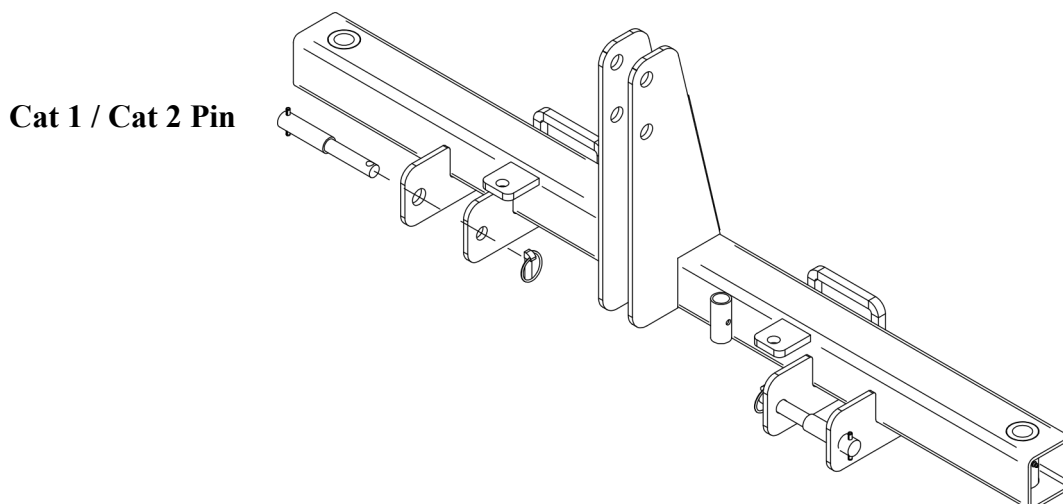

Operating Instructions

Clamp Arms:

Clamp arms can be reversed allowing for a wider grip range depending upon bale size. The Bale Unroller can handle both 4' and 5' round bales.

Arms Set to Narrow Position

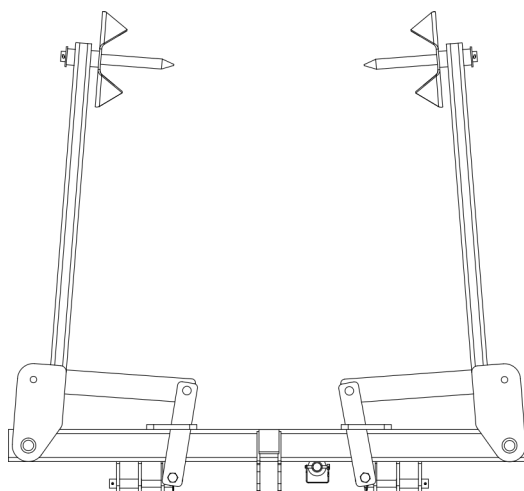

Arms Set to Widest Position

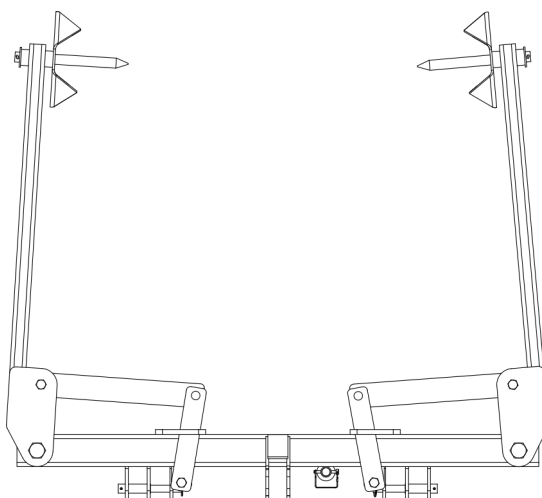

Operating Instructions

Operating the Bale Unroller:

- Prior to operating, make sure all potential operator's read and understand the safety warnings and precautions in the Bale Unroller operator's manual along with the tractor operator's manual.
- The tractor should be properly counterbalanced with weights before attempting to lift bales.
- Keep all bystanders out of work area. Bales are heavy and can cause serious injury or death.
- Prior to attempting to move or unroll a large round bale, determine which way the bale is wrapped. The bale should be clamped in a manner that allows the material to unroll from the bottom as shown in diagram below.
- Operate the tractor hydraulics to open arms and back up tractor with bale unroller attached to clamp the bale. The spikes should be as close to center of the hay bale as possible to allow for proper unrolling. Once centered, operate the tractor hydraulics to clamp the hay bale. The spikes should be inserted as far as possible to assure for solid contact with the hay bale.
- Remove twine or netting from bale prior to unrolling and dispose of properly.
- To unroll the hay bale, lower the bale so it contacts the ground and slowly drive forward. Make sure as the tractor moves forward, the hay bale is unrolling. If not, it may be necessary to increase down pressure on bale.

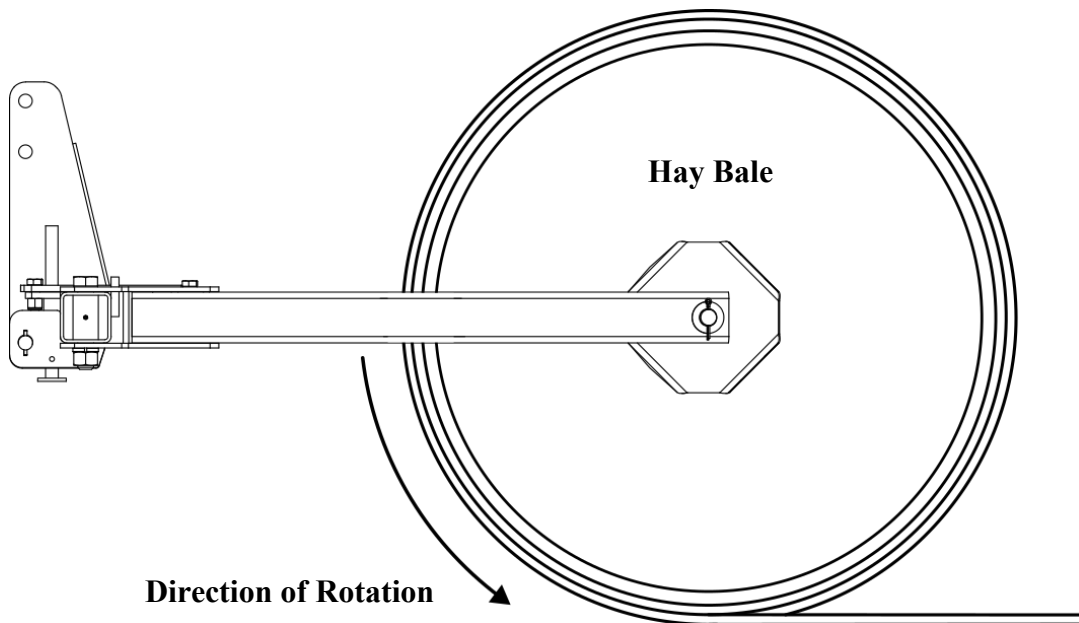

Maintenance/Storage

Maintenance:

- Periodically lubricate all pivot points and spinners.
- Inspect hardware to make sure they are properly tightened to specifications. See Torque Specification Chart, page 19.
- Inspect Bale Unroller parts for wear and replace as needed. Use only OEM parts to prevent voiding warranty.
- Inspect hydraulic hoses and fittings for leaks. Make sure the hoses are not pinched or rubbing during operation. **WARNING: See HYDRAULIC WARNING BELOW!**



! WARNING

- Avoid serious injury from injection of pressurized hydraulic fluid.
- Always relieve pressure before performing service or maintenance on any hydraulic components. Refer to tractor and implement Operator's Manuals.
- Do not use hands to search for leaks. Use cardboard or similar material.

9270110

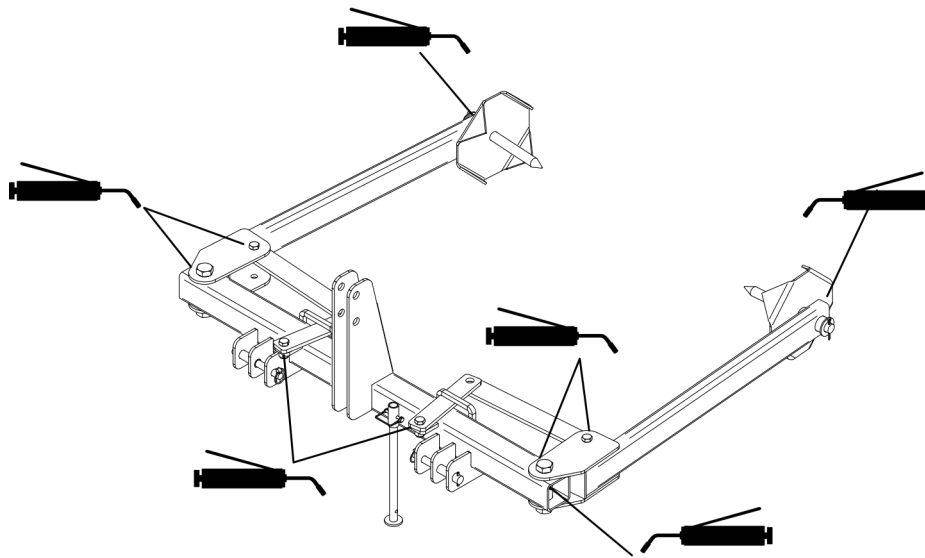

Grease Points

Storage:

- Store the Bale Unroller on a solid, level surface in a clean and dry location.

Torque Specifications

Torque Specifications for Common Bolt Sizes															
Inches		Bolt Head Identification						Metric		Bolt Head Identification					
										5.8		8.8		10.9	
Bolt size (inches)	Thread pitch	Grade 2		Grade 5		Grade 8		Class 5.8		Class 8.8		Class 10.9			
		N.m	ft-lb	N.m	ft-lb	N.m	ft-lb	N.m	ft-lb	N.m	ft-lb	N.m	ft-lb		
1/4"	20	7	5	11	8	16	12	M5	0.08	4	3	6	4	9	7
1/4"	28	8	6	13	10	19	14	M6	1	6	4	10	7	15	11
5/16"	18	15	11	24	17	33	25	M8	1.25	16	12	25	18	36	27
5/16"	24	17	13	26	19	37	27	M8	1	17	13	26	19	38	28
3/8"	16	27	20	42	31	59	44	M10	1.5	31	23	48	35	71	52
3/8"	24	31	23	47	35	67	49	M10	1.25	33	24	51	38	75	55
7/16"	14	43	32	67	49	95	70	M10	1	35	26	53	39	78	58
7/16"	20	48	36	75	55	106	78	M12	1.75	54	40	84	62	123	91
1/2"	13	66	48	102	75	144	106	M12	1.5	56	41	87	64	128	94
1/2"	20	75	55	115	85	163	120	M12	1.25	59	44	90	66	133	98
9/16"	12	95	70	147	109	208	154	M14	2	84	62	133	98	195	144
9/16"	18	106	79	164	121	232	171	M14	1.5	94	69	142	105	209	154
5/8"	11	132	97	203	150	287	212	M16	2	131	97	206	152	302	223
5/8"	18	149	110	230	170	325	240	M16	1.5	141	104	218	161	320	236
3/4"	10	233	172	361	266	509	376	M18	2.5	181	133	295	218	421	310
3/4"	16	261	192	403	297	569	420	M18	2	196	145	311	229	443	327
7/8"	9	226	167	582	430	822	606	M18	1.5	203	150	327	241	465	343
7/8"	14	249	184	642	473	906	668	M20	2.5	256	189	415	306	592	437
1"	8	339	250	873	644	1232	909	M20	1.5	288	212	454	335	646	476
1"	12	371	273	955	704	1348	995	M22	2.5	344	254	567	418	807	595
1-1/8"	7	480	354	1077	794	1746	1288	M22	1.5	381	281	613	452	873	644
1-1/8"	12	539	397	1208	891	1958	1445	M24	3	444	327	714	526	1017	750
1-1/4"	7	677	500	1519	1120	2463	1817	M24	2	488	360	769	567	1095	808
1-1/4"	12	750	553	1682	1241	2728	2012	M27	3	656	484	1050	774	1496	1103
1-3/8"	6	888	655	1992	1469	3230	2382	M27	2	719	530	1119	825	1594	1176
1-3/8"	12	1011	746	2268	1673	3677	2712	M30	3.5	906	668	1420	1047	2033	1499
1-1/2"	6	1179	869	2643	1949	4286	3161	M30	2	1000	738	1600	1180	2250	1659
1-1/2"	12	1326	978	2974	2194	4823	3557	M36	4	1534	1131	2482	1830	3535	2607

Notes:

This chart is an approximate estimate of torque values.

Always tighten hardware to these values unless a different torque value or tightening procedure is listed for a specific application.

Fasteners must always be replaced with the same grade as specified in the manual.

Always use the proper tool for tightening hardware: SAE for SAE hardware and Metric for Metric hardware.

Page left blank intentionally



Bale Unroller

TRBU-100

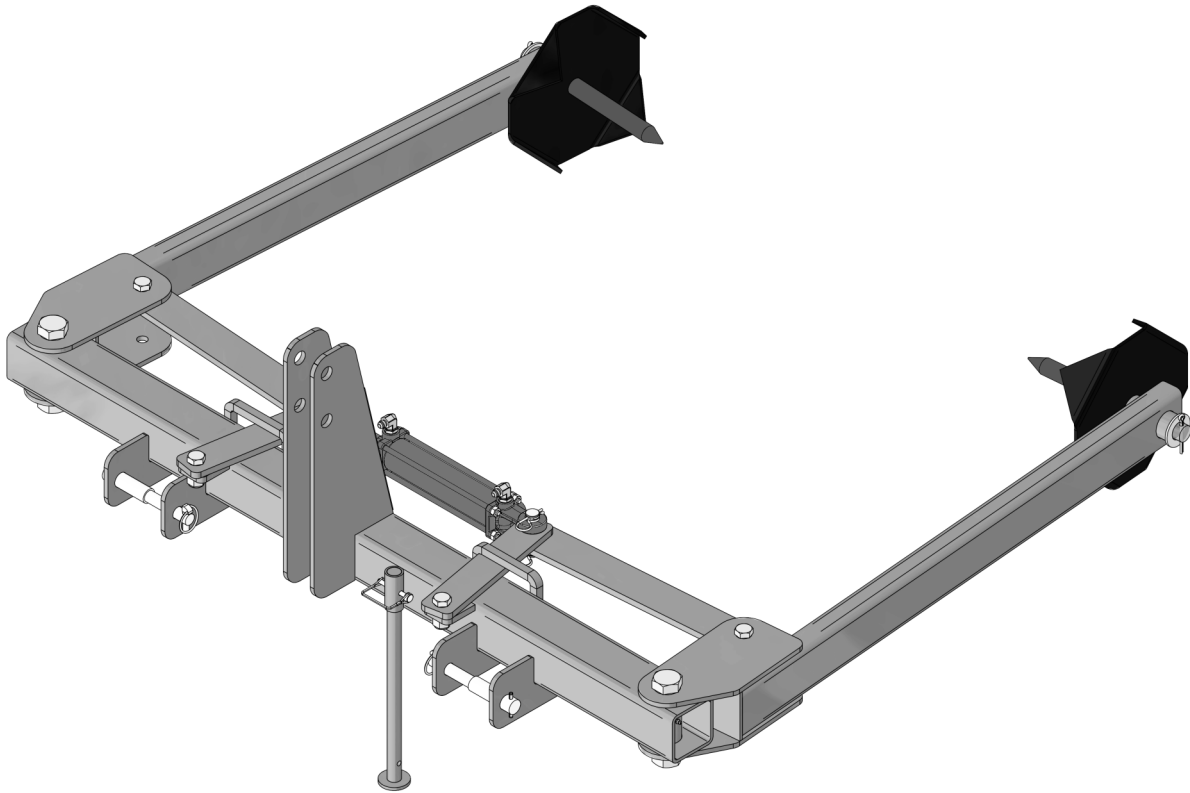

Parts Manual

Rel. 12/25

Frame Assembly

Version 2 Frame

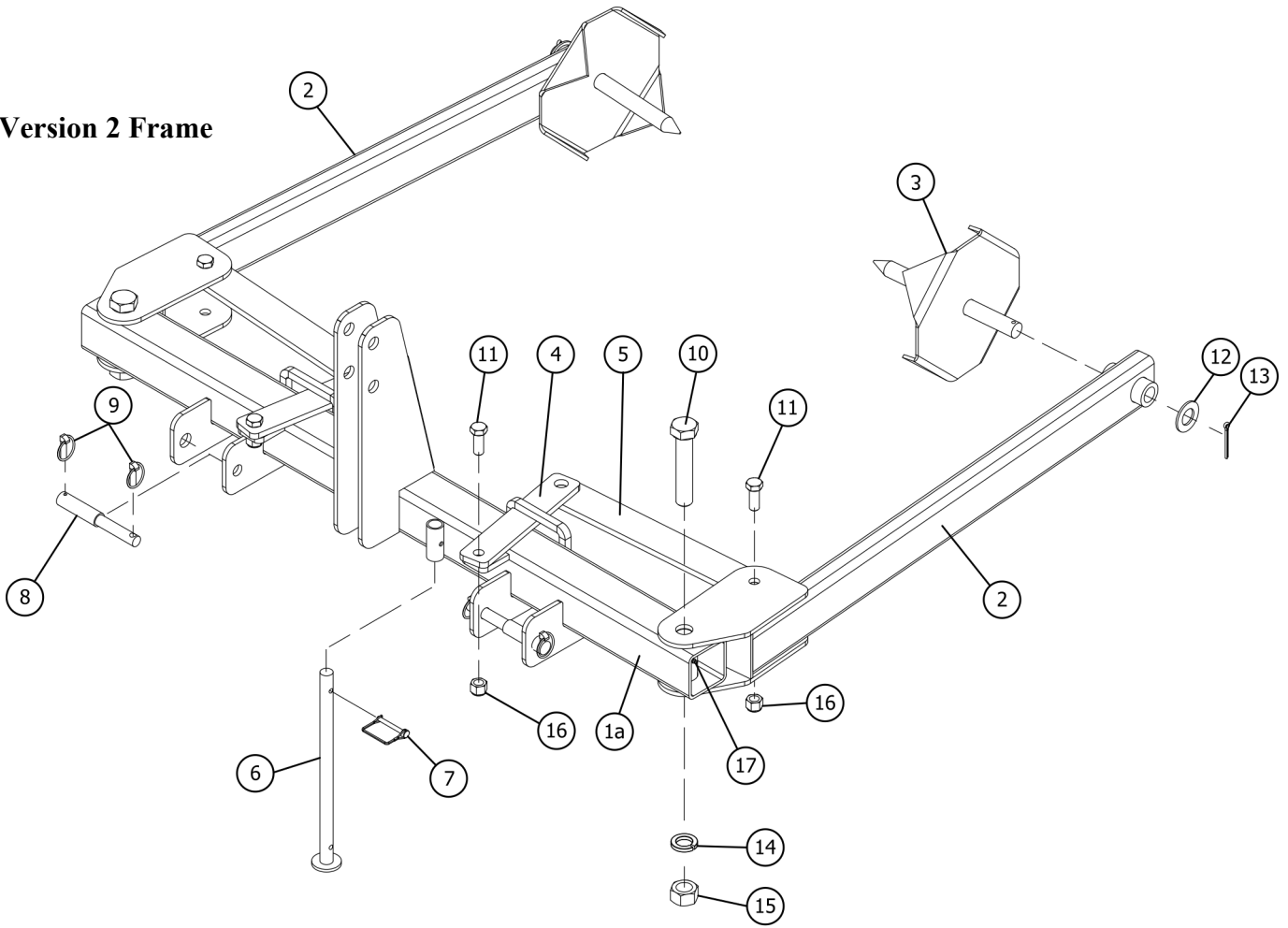

Version 1 Frame

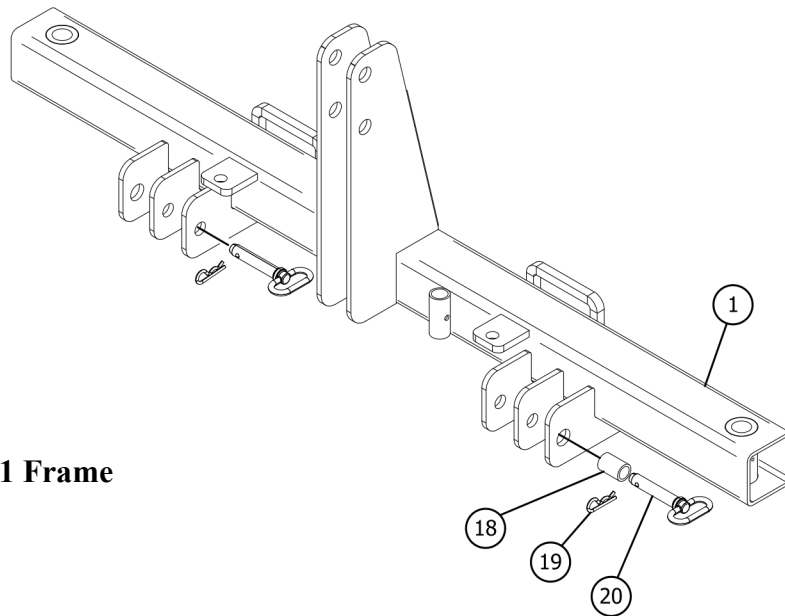

Frame Assembly

Item	Part #	Description	Qty.
1	TRBU40001	Main frame TRBU-100 (version 1) *See Notes Below	1
1a	TRBU40002	Main frame TRBU-100 (version 2) *See Notes Below	1
2	TRBU40003	Clamping arm	2
3	TRBU40004	Spinner	2
4	TRBU40005	Arm, short	2
5	TRBU40006	Arm, long	2
6	TRBU40007	Stand TRBU-100	1
7	DLYNPN08	D Shape lynch pin M8	1
8	SA4059	Step pin Cat1/Cat2	2
9	LYNPN10	Lynch pin M10	2
10	BS1.25-7x6.5	Bolt HH 1-1/4"-7x6.5"	2
11	BS3/4-10x2	Bolt HH 3/4"-10x2"	4
12	FW1-1/4	Washer flat 1-1/4"	2
13	CP1/4x2-1/2	Cotter pin 1/4"x2-1/2"	2
14	LW1-1/4	Washer lock 1-1/4"	2
15	NS1.25-7	Nut HH 1-1/4"-7	2
16	NS3/4-10	Nut HH 3/4"-10	4
17	TRBU40017	Grease fitting	2
18	TRBU40015	Bushing 1-1/8"ID/ODx1-3/4"	2
19	RC5	R clip M5	2
20	TRBU40016	Lower hitch pin	2

***Notes:**

Prior to ordering replacement parts, check the serial number your Bale Unroller.

Version 1, Serial #'s 2500 thru 2509

Version 2, Serial #'s 2510 and up

Hydraulics

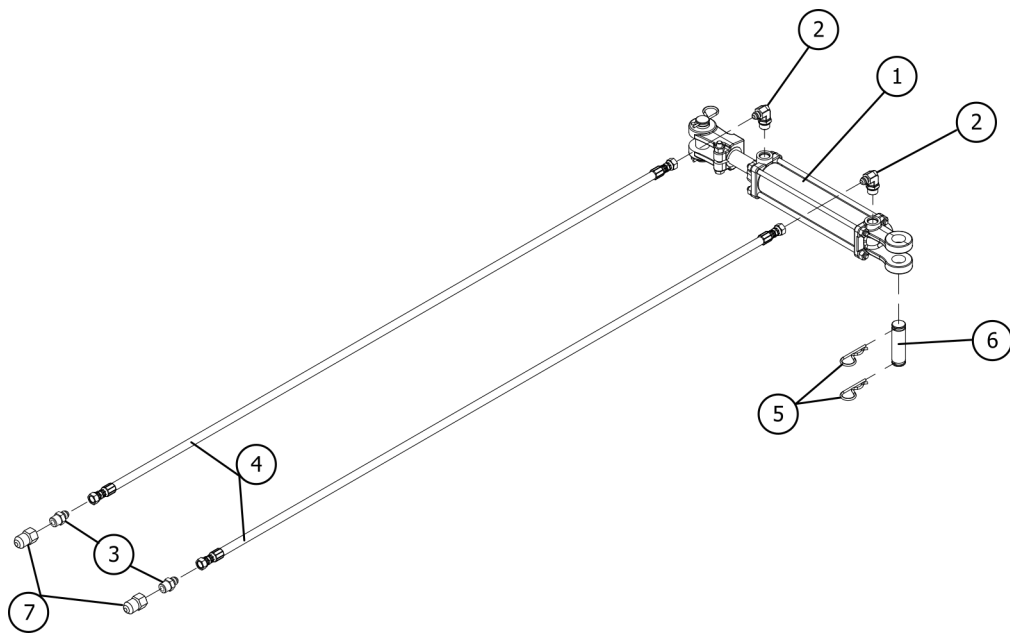

Hydraulics

Item	Part #	Description	Qty.
1	TRBU40008	Hydraulic cylinder TRBU-100	1
2	TRBU40009	Hydraulic elbow 08MORB x 08MJIC (version 1) *See Notes Below	2
	TRBU40010	Hydraulic elbow 06MORB x 06MJIC (version 2) *See Notes Below	2
3	TRBU40011	Hydraulic adaptor 08MP-08MJIC (version 1) *See Notes Below	2
	TRBU40012	Hydraulic adaptor 08MP-06MJIC (version 2) *See Notes Below	2
4	TRBU40013	Hydraulic hose TRBU-100 (version 1) *See Notes Below	2
	TRBU40014	Hydraulic hose TRBU-100 (version 2) *See Notes Below	2
5	RC4	R-clip M4	4
6	TRBU40018	Cylinder pin Ø1.00”X3.50”	2
7	86641B	Male quick disconnect	2

***Notes:**

Prior to ordering replacement parts, check the serial number your Bale Unroller.

Version 1, Serial #'s 2500 thru 2509

Version 2, Serial #'s 2510 and up

Decals

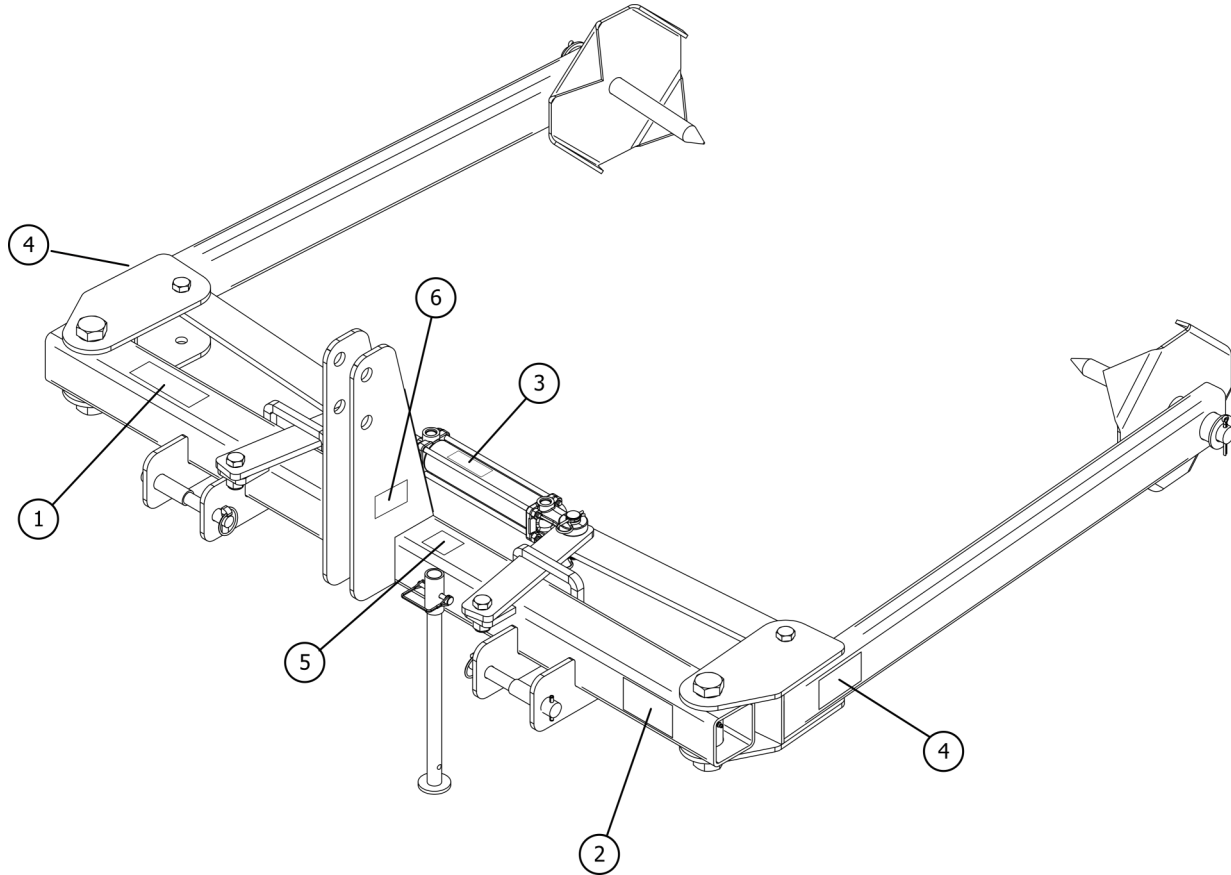

Item	Part #	Description	Qty.
1	NA	Model # TRBU-100	1
2	D1350	Decal Caution "Read Manual"	1
3	9270110	Decal Warning High Pressure	1
4	D1352	Decal Danger Hay Bales	2
5	D1335	Notice 2000 lb. Capacity	1
6	NA	Serial Tag TRBU	1

Decals

1 TRBU-100

2

⚠ CAUTION

To avoid serious injury:

- Read Operator's Manual before operating, servicing or repairing equipment. Follow all safety rules and instructions. (Manuals are available from your selling dealer.
- Never allow riders.
- Keep bystanders away from equipment during operation.
- Operate from tractor seat only.
- Keep all shields in place and in good condition.
- Lower equipment to ground, stop engine, remove key and set brake before dismounting tractor.
- Never allow children or untrained person to operate equipment.

D-1350

3



⚠ WARNING

- Avoid serious injury from injection of pressurized hydraulic fluid.
- Always relieve pressure before performing service or maintenance on any hydraulic components. Refer to tractor and implement Operator's Manuals.
- Do not use hands to search for leaks. Use cardboard or similar material.

9270110

4

⚠ DANGER



To avoid serious injury or death:

- Unload bales only on level surfaces.
- Never allow bystanders in work area when loading and unloading of bales.

D1352

5

NOTICE

2000 LB.

CAPACITY

D1335

Warranty

LIMITED WARRANTY

Belco Resources Equipment warrants to the original purchaser of any new piece of machinery from Belco Resources Equipment, purchased from an authorized Belco Resources Equipment dealer, that the equipment be free from defects in material and workmanship for a period of one (1) year for non-commercial, state, and municipalities' use, ninety (90) days for commercial use from date of retail sale. Warranty for rental purposes is thirty (30) days. The obligation of Belco Resources Equipment to the purchaser under this warranty is limited to the repair or replacement of defective parts.

Replacement or repair parts installed in the equipment covered by this limited warranty are warranted for ninety (90) days from the date of purchase of such part or to the expiration of the applicable new equipment warranty period, whichever occurs later. Warranted parts shall be provided at no cost to the user at an authorized Belco Resources Equipment dealer during regular working hours. Belco Resources Equipment reserves the right to inspect any equipment or parts, which are claimed to have been defective in material or workmanship.

This limited warranty does not apply to and excludes wear items such as shear pins, tires, tubes knives, blades or other wear items. Oil or grease is not covered by this warranty.

All obligations of Belco Resources Equipment under this limited warranty shall be terminated if:

- Proper service is not performed on the machine.

- The machine is modified or altered in any way.

- The machine is being used or has been used for purposes other than those for which the machine was intended.

DISCLAIMER OF IMPLIED WARRANTIES & CONSEQUENTIAL DAMAGES

Belco Resources Equipment obligation under this limited warranty, to the extent allowed by law, is in lieu of all warranties, implied or expressed, including implied warranties of merchantability and fitness for a particular purpose and any liability for incidental and consequential damages with respect to the sale or use of the items warranted. Such incidental and consequential damages shall include but not be limited to: transportation charges other than normal freight charges; cost of installation other than cost approved by Belco Resources Equipment; duty; taxes; charges for normal service or adjustment; loss of crops or any other loss of income; rental of substitute equipment, expenses due to loss, damage, detention or delay in the delivery.

REGISTRATION

The online Warranty Registration must be completed in order to qualify for coverage on this Limited Warranty. Visit br-equipment.com, click on "Warranty Registration" and completely fill out the form to register the new piece of equipment.

Page left blank intentionally

Page left blank intentionally

Page left blank intentionally



401 Jeffreys Road
Rocky Mount, NC 27804
www.tarrivermfg.com

Tel: 252-822-7140
Fax: 252-787-5855
Sales@tarrivermfg.com